

# POE Wall mount Video Intercom Terminal

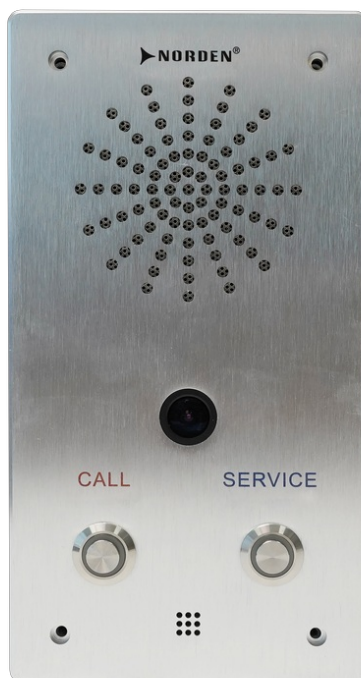

## DESCRIPTION

The NVS-IP100023IC is a POE wall mount Video Intercom terminal, with double-key design which has one-touch calling and one touch service to realize full duplex intercom. It is integrated with 1080P HD camera which supports Wide Dynamic Range with functions of strong light inhibition and weak light compensation, enable it to function properly under the circumstance of strong light and weak light. It adopts 6mm thick aluminium panel, with stab protection and special screw which is being able to activate warning siren whenever the equipment has been forcibly damaged. It is equipped with standard RJ45 interface which is accessible to the system wherever Ethernet is available that supporting cross-segment and cross-router.

## FEATURES

- ⦿ Robust 6 mm aluminium panel with specific screws and anti-stab protection to prevent vandalism
- ⦿ Built-in 1080P HD camera, 3W speaker, and microphone for hands-free calling
- ⦿ Line-output interface for connection to external active speakers or earphones
- ⦿ Relay I/O interface for system linkage or access control
- ⦿ Supports offline calling with pre-defined targets on its web interface
- ⦿ One-press calling feature with targets set via NORDEN management software
- ⦿ Fully compliant with standard SIP protocols for seamless integration with SIP PBX systems like Asterisk, Cisco, Yeastar, etc.
- ⦿ IEEE 802.3af interface support for flexible deployment
- ⦿ Equipped with online upgrading capabilities and remote management for continuous system improvement

## Specifications

Model	NVS-IP100023IC
Power Supply	DC24V/1A, PoE (IEEE802.3af)
Standby Power Consumption	≤3W
Signal to Noise Ratio	Broadcast Speaker: 81dB
	Broadcast Line: 88dB
	Line-in Record out: 82dB
Audio Sampling & Bit Rate	22.05KHz, 16bit, 8kbps~320kbps

# POE Wall mount Video Intercom Terminal

Video Transmission Bit Rate	512Kbps~4Mbps
Video Coding	VGA/720P/1080P
Built-in Speaker (Power Output)	3W
Built-in Speaker (Impedance)	8Ω
Built-in Mic	Electret Microphone
Built-in Mic (Sensitivity)	-45±3dB
Built-in Mic (Directivity)	Omnidirectional
Harmonic Distortion	<1%
Frequency Response	40Hz~10KHz (WAV) 50Hz~20KHz (MP3)
Network Interface	10BASE-T/100BASE-TX RJ45
Network protocol	TCP/IP, UDP, ARP, ICMP, IGMP, SIP, HTTP, FTP
Configuartion Method	Web Interface
Mounting Method	Wall Mounted
Installation Environment	Dry Indoor Locations
Operating Temperature	-20°C~55°C (-4°F~131°F)
Operating Humidity	≤90% RH (Non-Condensing)
Body Material	Aluminium Alloy
Colour	Silver
Back Shell Material	Steel
Product Dimension	101x191x46 mm
Product Weight	0.95 Kg

## FRONT PANEL

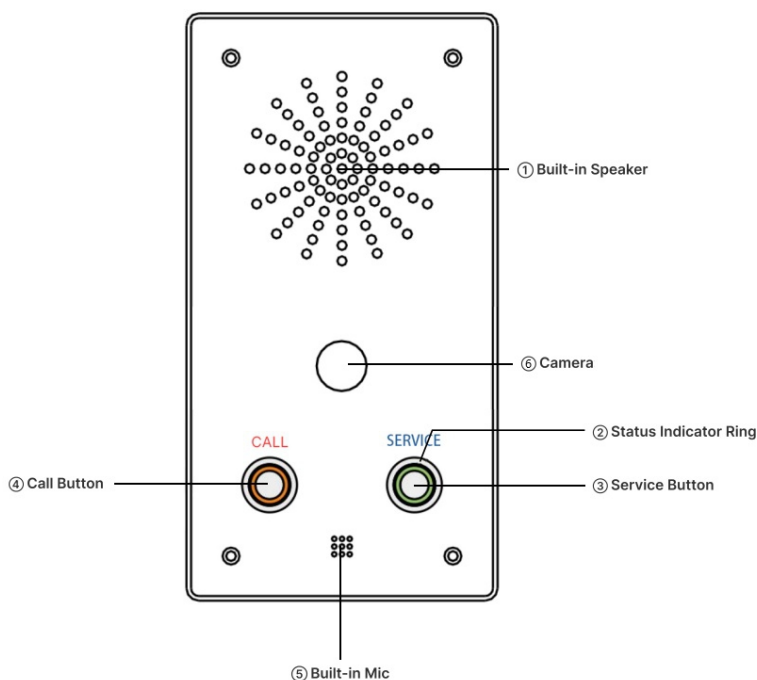

# POE Wall mount Video Intercom Terminal

## CONNECTION DIAGRAM

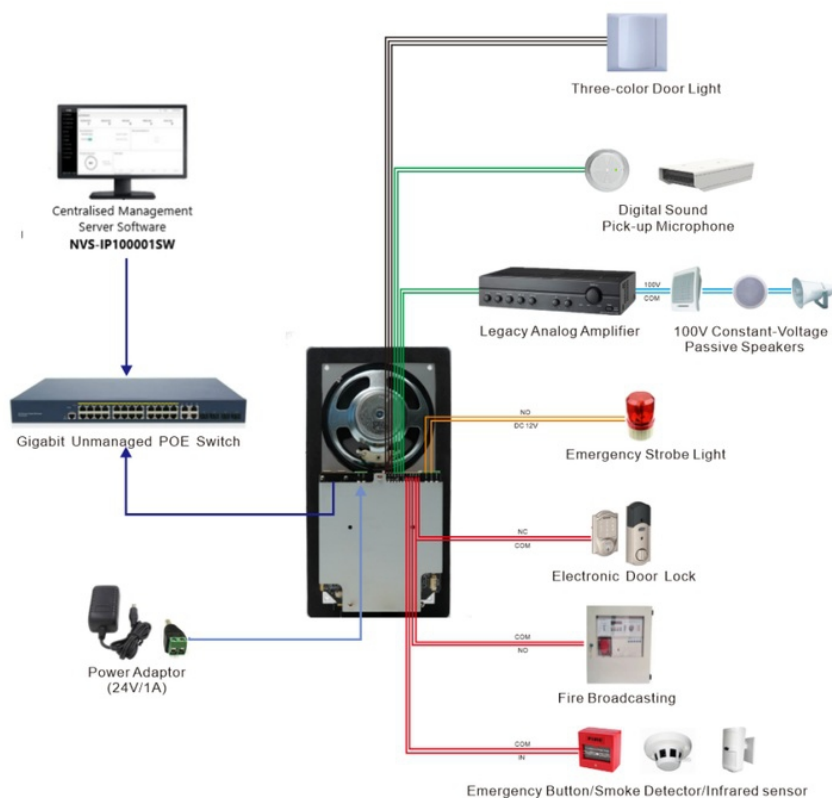

## Input Connection

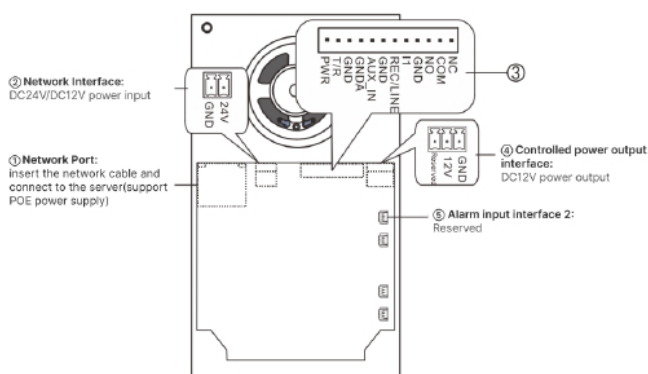

Comprehensive interface and function definition are shown in the figure below

NC	Alarm output (NC:normally closed,COM:COM,NO:normally open)
COM	
NO	
GND	Alarm input 1 (GND:Ground,L1:alarm input)
I1	
REC/LINE	Record out/line out interface(REC/LINE:Signal,GND:ground)
GND	
AUX_IN	Line in interface(AUX_IN:Signal,GNDA:Analog ground)
GNDA	
GND	
T/R	Three-color door light interface(GND:Ground,T/R:Signal,PWR:Power)
PWR	

# POE Wall mount Video Intercom Terminal

## DIMENSION

Unit mm

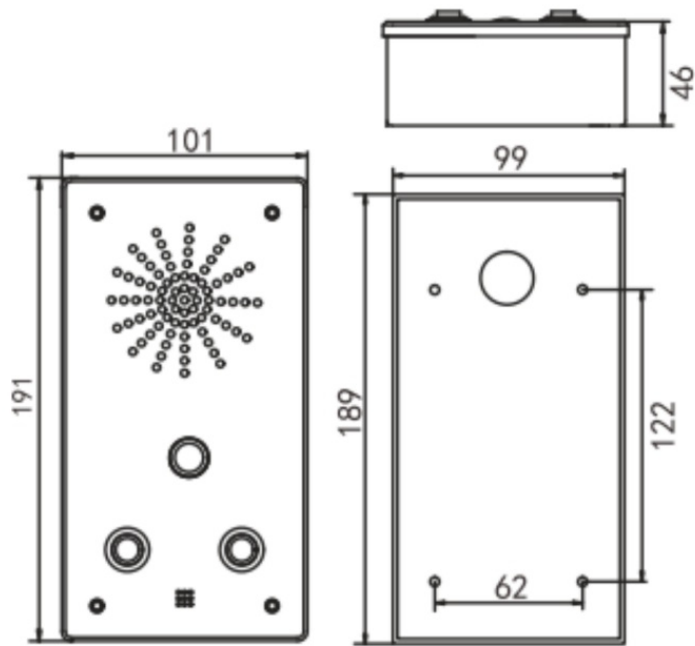

## ORDERING INFORMATION

Part Number	Description	Standard Quantity
NVS-IP100023IC	POE Wall mount Video Intercom Terminal	01

## ACCESSORIES INFORMATION

Description	Standard Quantity
Power Adaptor (24V/1A)	01
Allen Screw (M3*12)	04
Allen Wrench (2.5mm)	01
Wiring Terminal (3.5-2P)	01
Wiring Terminal (3.5-3P)	01
Half Round Head Philips Screw (ST4*25)	04
Red-Black Line (X2-80)	01
Red-White Line (X12-100)	01
Quality Certificate & Warranty Card	01
Quick Installation Guide	01