

2MP FIXED VANDAL DOME CAMERA



ENC-HVD5F-30R-93

FEATURES

Starlight Illumination
2.8 mm Fixed Lens
Smart IR up to 30m
ONVIF Profile (S,G,T)
Triple Stream
Built-in Mic
PoE, IP67, IK10

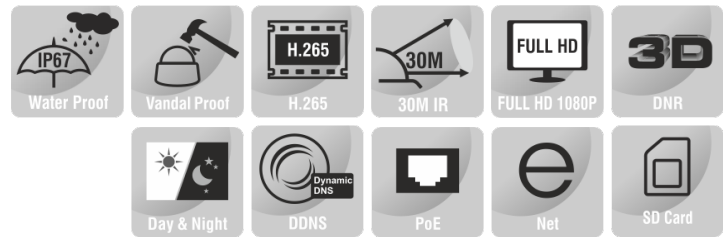

SPECIFICATION

MODEL		Model No.	ENC-HVD5F-30R-93
		Type	2MP FIXED VANDAL DOME CAMERA
CAMERA	Image Sensor	1/2.8" CMOS Progressive 2.0 MegaPixel	
	Day/Night	IR Cut Filter with Auto Switch	
	Lens Type	Fixed	
	Focal Length	2.8 mm	
	Iris	Fixed	
	Lens Mount	M12	
	Angle of View (H)	101.3°	
	Angle of View (V)	57.1°	
	Angle Adjustment	Pan 0~330°, Tilt 0~75°, Rotate 0~350°	
	Aperture Range	F1.6	
	Shutter	1s to 1/100,000s	
	Min. Illumination	Color: 0.001 lux @ F1.6, B/W: 0 lux with IR	
	AGC	Auto / Manual	
	Digital Noise Reduction	3D DNR	
	S/N Ratio	55 dB	
	Defog	Digital Defog	
WDR	120 dB		
Smart IR	Up to 30 m		
Wavelength	850 nm		
White LEDs	N/A		

None

★Product specification and availability are subject to change without notice.

2MP FIXED VANDAL DOME CAMERA



ENC-HVD5F-30R-93

MODEL	Model No.	ENC-HVD5F-30R-93
	Type	2MP FIXED VANDAL DOME CAMERA
VIDEO	Max. Resolution	1920x1080
	Video Compression	H.265+, H.265, H.264, MJPEG
	Main Stream	Main Stream: (1920x1080, 1280x720, 704x480, 640x480) @ 30fps, (1920x1080, 1280x720, 704x576, 640x480) @ 25fps Sub Stream: (704x480, 704x240, 640x360, 352x240) @ 30fps, (704x576, 704x288, 640x360, 352x288) @ 25fps Third Stream: (704x480, 704x240, 352x240) @ 30fps, (704x576, 704x288, 352x288) @ 30fps
	Stream Settings	i-Frame, PAL/NTSC, Frame Rate (1~30FPS), EIS, SVC
	Video Bit Rate	32 kbps ~ 8 Mbps
	Bitrate Type	CBR, VBR
	Image Settings	Brightness, Contrast, Saturation, Hue, Sharpness, Rotation/Mirror, Gain, Exposure, Day/Night
	White Balance	Auto, Semi Auto, Sunshine, Daylight, Warm Light, Filament, Nature Light, Lock WB, Manual
	Corridor Mode	Supported
	HLC	Supported
	BLC	Supported
	OSD	Total 8 regions
	OSD Type	Title, Week, Date, Time, Text with different colors and adaptable sizes (16x16, 32x32, 48x48, 64x64), Image overlay
	ROI	Up to 8 regions
Privacy Mask	Up to 4 regions	
Heatmap	Supported	
AUDIO	Audio Compression	G.711A, G.711U, ADPCM_D, AAC_LC
	Audio Bit Rate	8 kbps ~ 48 kbps
	Audio I/O	N/A
	Audio Voltage	N/A
	Built-in Mic	Supported with noise cancellation
SMART	Behavior Detection	Intrusion (Perimeter), Crossline (Tripwire), Double Crossline (Double Tripwire)
	Intelligent Identification	Loitering, Running, Abandoned Object (Object Left), Missing Object (Object Lost), Parking
	Statistical Analysis	Face Detection (Capture), People Counting, Crowd Detection, On Duty Detection, Helmet Detection, Human & Vehicle Classification, Abnormal Video & Audio Detection
	Alarm Management	Motion Detection, Tampering (Masking), Input & Output Event, IP & MAC Address Conflict, Disk Alarm (Full & RW Error), FTP Server Exception, Abnormal Voltage, Pre/Post Alarm Recording, Alarm Recording/Snapshot
INTERFACE	Protocols	TCP/IP, UDP, IPv4, IPv6, ICMP, HTTP, HTTPS, FTP, NFS, DHCP, DNS, DDNS, RTP, RTSP, RTCP, RTMP, PPPoE, NTP, UPnP, SMTP (SSL/TLS), IGMP, 802.1X, QoS (DSCP), Unicast, Multicast, ARP, SNMP, SSL, Telnet, SFTP (SSH), P2P
	Security	AES Video Encryption, IP Filter, User Authentication (Multiple Privilege Level), 802.1X Authentication (EAP-MD5), HTTPS Authentication, Digest Authentication, User Access Log
	Compatibility	ONVIF Profile (S, G, T), SDK/API/CGI
	Network	1 x RJ45 10M/100M Self Adaptive Ethernet Port
	Wi-Fi	N/A
	Alarm Interface	N/A
	Alarm Voltage	N/A
	RS485	N/A
	RS232	N/A
	USB	N/A
	Edge Storage	Built-in MicroSD card slot, up to 512 GB
	ANR	Supported
	Built-in Speaker	N/A
	Built-in Heater	N/A
Cable Interface	Cable Free	
Remote Connection	≤7	
Web Client	EyeConnect	
Web Language	16	

None

★Product specification and availability are subject to change without notice.

2MP FIXED VANDAL DOME CAMERA



ENC-HVD5F-30R-93

MODEL	Model No.	ENC-HVD5F-30R-93
	Type	2MP FIXED VANDAL DOME CAMERA
GENERAL	Power Supply	12V DC, PoE (IEEE 802.3af)
	Max. Power Consumption	5 W (12V DC), 6 W (PoE)
	Working Temperature	-40 °C ~ 65 °C
	Working Humidity	0-95% RH (non-condensing)
	Ingress Protection	IP67
	Vandal Resistant	IK10
	Surge Protection	Supported
	Reset Button	Supported
	Dimensions	Φ120×90 mm
	Net Weight	0.45 Kg

Dimension Unit : mm

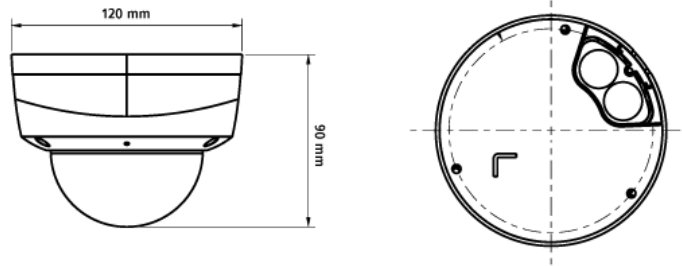

ORDERING INFORMATION

Part Number	Description	Standard Quantity
ENC-HVD5F-30R-93	2MP Starlight IR IP H.265 Vandal Proof Dome Camera with 2.8mm Fixed Lens, PoE, WDR, SD card slot, Built-in Mic, Smart Analytics and 30m IR support	1

PACKING INFORMATION

Part Number	Packing Mode	Gross weight(Kg)	Dimension(mm)
ENC-HVD5F-30R-93	Carton Box	0.65	138×138×110

None

★Product specification and availability are subject to change without notice.